

# Memorandum

**To:** BWCD BOARD OF DIRECTORS  
**From:** ERIC MANGEOT *EM*  
**CC:** CHRIS GEIGER  
**Date:** APRIL 2, 2019  
**File:** APPLICATION – LEAH SWAN AND PATRICK KING

**Applicant Name:** Leah Swan and Patrick King

**Type of Use:** Domestic  Commercial   
 Industrial  Agricultural

**Amount:** 0.8 AF 0.033 cfs 15 gpm

**Location:** Area A A-4 Area B  Inclusion   
 County: GARFIELD Contiguous:   
 BWCD Division: 4

**Mid Valley Metro District Notice Required?** Yes  No

**Blue Creek Water Rights Applied?** Yes  No

**02CW77 Umbrella Plan Water Rights Applied?** Yes  No  **Cost:** \$1,200

This application is to cover depletions associated with a single family dwelling and guest house, 10,000 square feet of lawn and landscape irrigation, and 8 livestock from an existing well on a property owned by Leah Swan and Patrick King (Applicant). The property is 3.12 acres located north of Planted Earth off of Highway 82. The physical address of the property is 12746 Highway 82, Carbondale, Colorado. Based on the property location, it is within BWCD Division 4. Total depletions are 0.8 acre-feet (AF) as estimated by Resource Engineering, Inc. A copy of the water requirement table is attached along with a BWCD map showing the location of the property.

All contract diversions will be from an existing well (Permit No. 66689-F) located in the SW1/4 SE1/4 of Section 27, Township 7 South, Range 88 West, of the 6<sup>th</sup> P.M. at a point 2,542 feet from the South Section line and 2,137 feet from the East section line as shown on **Figure 1**.

Water User :	Leah Swan and Patrick King
Analysis Date :	April 2, 2019
District Area :	A
Source Series:	4
Maximum Demand:	15 0.033 (GPM) (CFS)

**BASALT WATER CONSERVANCY DISTRICT  
WATER REQUIREMENTS**  
(acre feet)

Month	Total Demand				Consumptive Use						(12)* TOTAL	(13) Source of Aug/Replace	(14)* Delayed Depletion	
	(1) Domestic In-house	(2) Commercial or Other	(3) Lawn Irrigation	(4) Crop Irrigation	(5) Livestock	(6)* TOTAL	(7) Domestic In-house	(8) Commercial or Other	(9) Lawn Irrigation	(10) Crop Irrigation				(11) Livestock
January	0.067	0.000	0.000	0.000	0.008	0.079	0.010	0.000	0.000	0.000	0.008	0.020	GNM	0.043
February	0.060	0.000	0.000	0.000	0.008	0.071	0.009	0.000	0.000	0.000	0.008	0.018	GNM	0.043
March	0.067	0.000	0.000	0.000	0.008	0.079	0.010	0.000	0.000	0.000	0.008	0.020	GNM	0.043
April	0.064	0.000	0.023	0.000	0.008	0.100	0.010	0.000	0.018	0.000	0.008	0.039	GNM	0.047
May	0.067	0.000	0.112	0.000	0.008	0.196	0.010	0.089	0.000	0.000	0.008	0.119	GNM	0.081
June	0.064	0.000	0.139	0.000	0.008	0.222	0.010	0.111	0.000	0.000	0.008	0.142	GNM	0.101
July	0.067	0.000	0.133	0.000	0.008	0.218	0.010	0.106	0.000	0.000	0.008	0.137	GNM	0.100
August	0.067	0.000	0.081	0.000	0.008	0.164	0.010	0.065	0.000	0.000	0.008	0.091	GNM	0.081
September	0.064	0.000	0.074	0.000	0.008	0.154	0.010	0.059	0.000	0.000	0.008	0.084	GNM	0.075
October	0.067	0.000	0.027	0.000	0.008	0.107	0.010	0.021	0.000	0.000	0.008	0.044	GNM	0.053
November	0.064	0.000	0.000	0.000	0.008	0.076	0.010	0.000	0.000	0.000	0.008	0.020	GNM	0.044
December	0.067	0.000	0.000	0.000	0.008	0.079	0.010	0.000	0.000	0.000	0.008	0.020	GNM	0.043
<b>TOTALS →</b>	<b>0.784</b>	<b>0.000</b>	<b>0.587</b>	<b>0.000</b>	<b>0.099</b>	<b>1.543</b>	<b>0.118</b>	<b>0.470</b>	<b>0.000</b>	<b>0.000</b>	<b>0.099</b>	<b>0.754</b>		<b>0.754</b>

Area A-4  
Alluvial Well - Type A  
Permit No. 66689-F  
Roaring Fork River

		Assumptions	
(1)	NUMBER OF RESIDENCES	2	(5) # of Livestock @ 11 gals/day
	# persons/residence	3.5	8
	# gallons/person/day	100	(7) % CU for Domestic/Commercial
(2)	Commercial/Other Demand (af)	0.000	(9) % Lawn Irrig. Efficiency
			Consumption of Irrig. (af/ac)
(3)	Sq. Ft. of Lawn Irrigated	10000	(10) % Crop Irrig. Efficiency
	Lawn Application Rate (af/ac)	2.593	Consumption of Irrig. (af/ac)
(4)	Acres of Crop Irrigated	0.00	(9-10) Elevation (feet)
	Crop Application Rate (af/ac)	0.000	6240

\* (6) (12) Total Includes 5% Transit Loss (Ruedi)  
10% for Green Mountain Reservoir

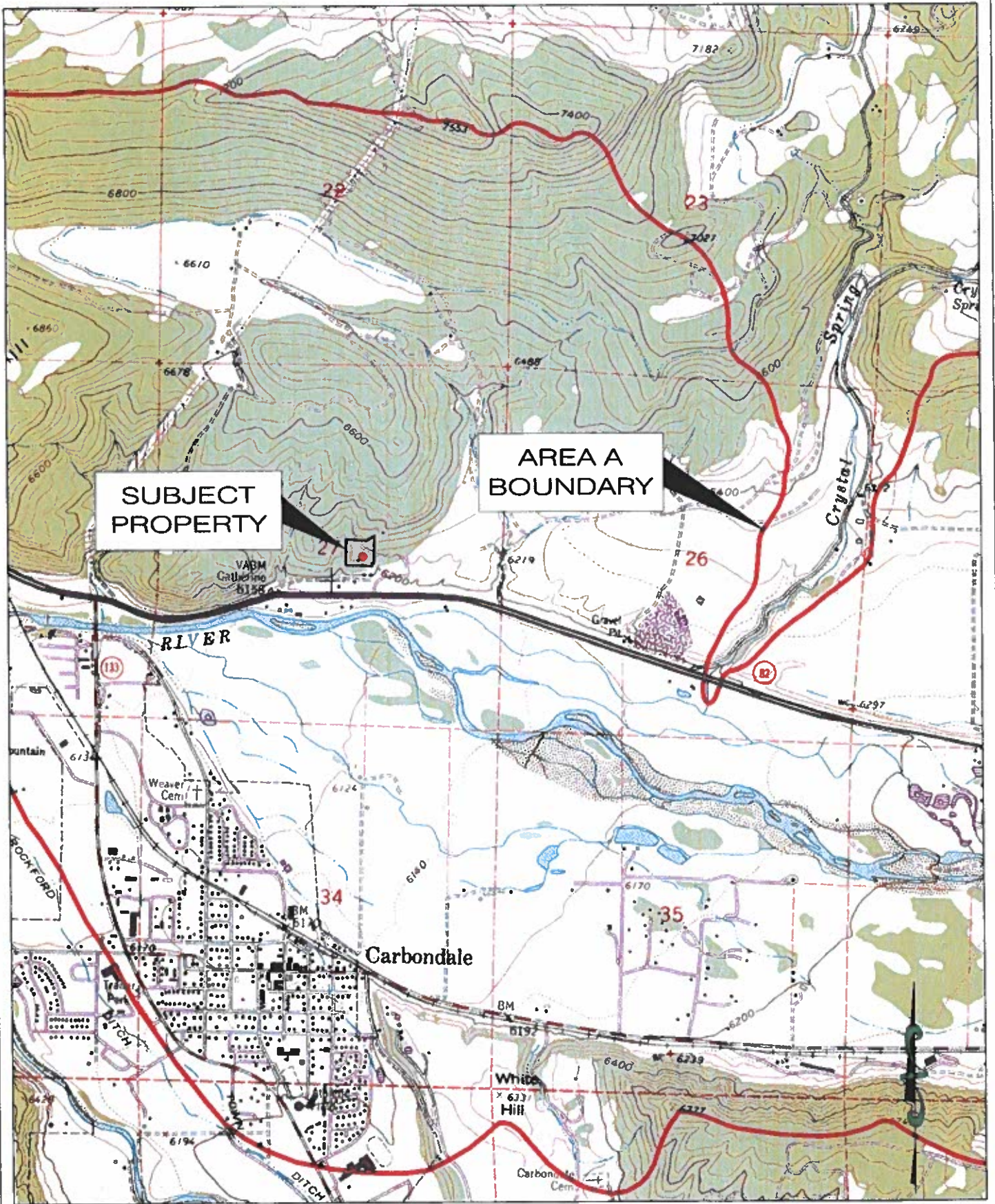
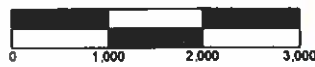

Figure 1: Leah Swan and Patrick King

Basalt Water Conservancy District

File: 033-7.2  
Date: 04/02/2019



Scale: 1"=2,000'

**RESOURCE**  
ENGINEERING, INC.

909 Colorado Avenue  
Greenwood Springs, CO 81501  
(970) 945-6777 Voice 945-1137 Facsimile

**APPLICATION FOR WATER ALLOTMENT CONTRACT  
BASALT WATER CONSERVANCY DISTRICT**

1. Applicant(s) Contact Information

- a. Name: Leah Swan and Patrick King
- b. Mailing Address: 12746 Highway 82  
Carbondale, CO 81623
- c. Street Address: 12746 Highway 82  
Carbondale, CO 81623
- d. Telephone Numbers: 207-838-0302 (Leah)
- e. Email Address: lswan105@gmail.com
- f. If Applicant is represented by an Attorney, please provide the Attorney's contact information, including name, address, telephone, and email:  
N/A
- g. Emergency Local Contact Information, including name, address, telephone, and email:  
Patrick King 207-653-9806  
patricktullyking@gmail.com
- h. Contact Information of property manager, caretaker, irrigator, system operator, or agent who should be provided a copy of this contract, including name, address, telephone, and email:  
N/A

2. Type of land use (development) proposed for water allotment contract (i.e. single family home, subdivision, gravel pit, etc.):

Single family home, guest house

3. Legal description and address of property on which District's water rights and/or contract water will be used (attach map and vesting deed with proof of ownership)\*:

SW 1/4 of the SE 1/4 SEC. 27 TWP. 7  
South range 88 West 6th P.M.

4. Elevation of property:  6-7,000 ft., \_\_\_\_\_ 7-8,000 ft., \_\_\_\_\_ 8-9,000 ft.

5. Name and legal description of water supply diversion point(s):

Name of Diversion Swan King Well.

Type of Diversion Well (e.g., a well, spring, ditch, pipeline, etc.)

Legal Description: SW Quarter, SE Quarter, Section 27, Township 7  
N / (S) Range 88 E / (W) of the 6<sup>th</sup> Principal Meridian, at a location  
2,542 feet from the S Section line and 2,137 feet  
from the E Section line.

UTM Coordinates (NAD 83):

Northing: \_\_\_\_\_.

Easting: \_\_\_\_\_.

\_\_\_\_\_ Zone 12/ \_\_\_\_\_ Zone 13.

If diversion point is a well, please provide the Well Permit No. 66689-F

Is the well operational/active?  Yes, \_\_\_\_\_ No

Is there currently an operating well meter? \_\_\_\_\_ Yes,  No

Notice: A valid well permit with operating well meter will be required under the contract.

6. Legal Water Supply: (please check one)

Applicant requests consideration by the District to be included in the District's Umbrella Plan for Augmentation decreed in Case No. 02CW77.\*

\*Note: Certain applicants may qualify to be included in the District's Umbrella Plan at the District's discretion. In order to be included in the District's Umbrella Plan, the Applicant's depletions must occur within the District's defined "Area A" and the Applicant must

reimburse the District its *pro rata* share of the District's expenses in obtaining the Umbrella Plan decree. Costs of reimbursement range from \$1,200 for contractees with less than 2 units (EQRs) to \$3,000 for more than 8 EQRs.

\_\_\_\_ Applicant will obtain its own plan for augmentation by applying to the Water Court, Water Division 5 within 2 years of this application. If Applicant has already applied for its own change/approval of plan for augmentation, the Water Court Case Number is: \_\_\_\_\_.

7. Proposed waste water treatment system: (please check)

- Tap to central waste water treatment facility
- Septic tank/leachfield system
- Evapotranspiration system
- Other:

8. Proposed use of water (please check)

- Domestic/Municipal (single family home(s), duplex(s), condominium(s), mobile home(s), apartment). Please complete page four of this application.
- Commercial (hotel, office, warehouse, restaurant, bar, retail). Please complete page five of this application.
- Industrial (gravel pit, manufacturing). Please complete page six of this application.
- Agricultural (crop irrigation, stock watering). Please complete page seven of this application.

Date on which the county or other applicable governmental entities approved the land use for which you seek legal water service: unknown. (Note: Copy of the Resolution of other documentation evidencing such approval should be submitted with application.)

9. What other water rights are associated with or used on the property?

N/A

10. What other uses of water occur on the property?

N/A

Please complete the section below if you selected domestic/municipal use on Page 3,  
No. 8

DOMESTIC/MUNICIPAL WATER USES

In-House

Single family residential home(s)	Number of Units: <u>2</u>
Duplex(s)	Number of Units: _____
Condominium(s)	Number of Units: _____
Apartment(s)	Number of Units/Rooms: _____
Mobile Home(s)	Number of Units: _____

Irrigation (lawns, parks, open space)

Total area to be irrigated 10,000 Sq. Ft. or \_\_\_\_\_ Acres

Type of irrigation system (please check)

X Sprinkler

\_\_\_\_\_ Flood (irrigation ditch)

Domestic stock watering (cattle, horses)

Number of animals: 8 horses

Period of use (months): 12

Other domestic/municipal uses not listed:

N/A

Please complete this page if you selected commercial use on Page 3, No. 8

COMMERCIAL WATER USES

In-House

Hotel: \_\_\_\_\_

Office(s), square footage: \_\_\_\_\_

Warehouse/distributor, square footage: \_\_\_\_\_

Retail, square footage: \_\_\_\_\_

Restaurant, number of seats: \_\_\_\_\_

Bar, number of seats: \_\_\_\_\_

Irrigation (lawns, parks, open space)

Total area to be irrigated \_\_\_\_\_ Sq. Ft. or \_\_\_\_\_ Acres

Type of irrigation system (please check)

\_\_\_\_\_ Sprinkler

\_\_\_\_\_ Flood (irrigation ditch)

Other Commercial Uses Not Listed:



Please complete this page if you selected industrial use on Page 3, No. 8

**INDUSTRIAL WATER USES**

Please describe your industrial development in some detail:

Irrigation (lawns, parks, open space)

Total area to be irrigated \_\_\_\_\_ Sq. Ft. or \_\_\_\_\_ Acres

Type of irrigation system (please check)

- \_\_\_\_\_ Sprinkler
- \_\_\_\_\_ Flood (irrigation ditch)

Please complete this page if you selected agricultural use on Page 3, No. 8.

AGRICULTURAL WATER USE

Irrigation

Type of crop(s) (pasture, alfalfa, beans, etc.) and irrigation system:

Crop: _____	Acres: _____	Sprinkler: _____	Flood: _____
Crop: _____	Acres: _____	Sprinkler: _____	Flood: _____
Crop: _____	Acres: _____	Sprinkler: _____	Flood: _____
Crop: _____	Acres: _____	Sprinkler: _____	Flood: _____

Stock Watering (cattle, horses)

Number of animals:

Months of use:

Other agricultural uses not listed:

VERIFICATION

STATE OF Colorado )  
 ) ss.  
COUNTY OF Garfield )

I, Leah Swan & Patrick King (name of Applicant or Applicant's duly authorized representative), being first duly sworn, upon oath, depose and state as follows:

- 1) I am the Applicant or a duly authorized officer, manager, agent or attorney-in-fact for the Applicant for this Application for Water Allotment Contract;
- 2) I have read and know the contents of this Application;
- 3) The information contained herein is an accurate and complete description of the Applicant's intended use of the Basalt Water Conservancy District's water rights;
- 4) The Applicant acknowledges that the accuracy and truth of all statements in this Application are conditions of approval of this Application by the Basalt Water Conservancy District and of the Contract to be made pursuant to such approval; and
- 5) I acknowledge that this application shall be subject to the District's Water Allotment Contract as approved and issued by the District.

Date: 3/22/19

By: [Signature]  
Print Name: Leah Swan  
Title: owners

Subscribed and sworn before me this 22 day of March, 2019  
by Leah Swan.

Witness my hand and seal.

[Signature]  
Notary Public

My commission expires:

