



Resource Engineering, Inc.  
909 Colorado Avenue  
Glenwood Springs, CO 81601  
(970)-945-6777 Voice  
(970)-945-1137 Facsimile

# Memorandum

To: BWCD BOARD OF DIRECTORS  
From: ERIC MANGEOT  
CC: CHRIS GEIGER  
Date: DECEMBER 15, 2017  
File: APPLICATION – STEFAN DAG

**Applicant Name:** Stefan Dag

**Type of Use:** Domestic  Commercial \_\_\_\_\_  
Industrial \_\_\_\_\_ Agricultural \_\_\_\_\_

**Amount:** 0.2 AF 0.033 cfs 15 gpm

**Location:** Area A A-4 Area B \_\_\_\_\_ Inclusion \_\_\_\_\_  
County: GARFIELD Contiguous: \_\_\_\_\_  
BWCD Division: 3

**Mid Valley Metro District Notice Required?** Yes \_\_\_\_\_ No

**Blue Creek Water Rights Applied?** Yes \_\_\_\_\_ No

**02CW77 Umbrella Plan Water Rights Applied?** Yes  No \_\_\_\_\_ **Cost:** \$1,200

This application is to cover depletions associated with a single family dwelling or ADU, 2,000 square feet of lawn and landscape irrigation, and water associated with a future hot tub for Stefan Dag (Applicant). The Applicant owns a 1.08 acre lot located at 848 County Road 106 near Carbondale, Colorado (Parcel No. 239328400014) and is located in Division 3 of the District. Total depletions associated with this contract are 0.2 acre-feet (AF) as estimated by Resource Engineering, Inc.

Diversions are to be from an existing well (Permit No. 39575-F) located in the NW1/4 SE1/4 of Section 28, Township 7 South, Range 88 West, of the 6<sup>th</sup> P.M. at a point 1,700 feet from the South section line and 2,100 feet from the East section line. The Applicant will need to amend their well permit to reflect the additional uses if the contract is approved. Contract No. 84 is also associated with this property; however, the contract cannot be amended as is included in the District's 98CW026/9WCW089 (consolidated) batch plan decree.

A copy of the water requirement table and calculation sheets are attached along with a BWCD map showing the location of the property.

Water User :	Stefan Dag
Analysis Date :	December 15, 2017
District Area:	A
Source Series:	4
Maximum Demand:	15 0.033 (GPM) (CFS)

**BASALT WATER CONSERVANCY DISTRICT  
WATER REQUIREMENTS**  
(acre feet)

Month	Total Demand				Consumptive Use							*(13) Delayed Depletions	(14) Source of Aug/Replace	
	(1) Domestic In-house	(2) Evap.	(3) Lawn Irrigation	(4) Crop Irrigation	(5) Livestock	(6) TOTAL	(7) Domestic In-house	(8) Evap.	(9) Lawn Irrigation	(10) Crop Irrigation	(11) Livestock			(12) TOTAL
January	0.033	0.000	0.000	0.000	0.000	0.033	0.005	0.000	0.000	0.000	0.000	0.005	0.009	GNM
February	0.030	0.000	0.000	0.000	0.000	0.030	0.005	0.000	0.000	0.000	0.000	0.005	0.009	GNM
March	0.033	0.000	0.000	0.000	0.000	0.034	0.005	0.000	0.000	0.000	0.000	0.005	0.009	GNM
April	0.032	0.000	0.005	0.000	0.000	0.038	0.005	0.004	0.000	0.000	0.000	0.009	0.010	GNM
May	0.033	0.001	0.023	0.000	0.000	0.057	0.005	0.018	0.000	0.000	0.000	0.024	0.017	GNM
June	0.032	0.001	0.028	0.000	0.000	0.061	0.005	0.022	0.000	0.000	0.000	0.028	0.021	GNM
July	0.033	0.001	0.027	0.000	0.000	0.061	0.005	0.021	0.000	0.000	0.000	0.027	0.021	GNM
August	0.033	0.001	0.016	0.000	0.000	0.050	0.005	0.013	0.000	0.000	0.000	0.019	0.017	GNM
September	0.032	0.001	0.015	0.000	0.000	0.048	0.005	0.012	0.000	0.000	0.000	0.017	0.016	GNM
October	0.033	0.000	0.006	0.000	0.000	0.039	0.005	0.005	0.000	0.000	0.000	0.010	0.011	GNM
November	0.032	0.000	0.000	0.000	0.000	0.032	0.005	0.000	0.000	0.000	0.000	0.005	0.009	GNM
December	0.033	0.000	0.000	0.000	0.000	0.033	0.005	0.000	0.000	0.000	0.000	0.005	0.009	GNM
TOTALS -->	0.392	0.006	0.119	0.000	0.000	0.517	0.059	0.006	0.096	0.000	0.000	0.160	0.160	

**Well Type A**  
Permit No. 39575-F  
Tributary to Roaring Fork River

		Assumptions			
(1)	NUMBER OF RESIDENCES	1	(5)	0	
	# persons/residence	3.5			
	# gallons/person/day	100	(7)	15	
(2)	Commercial/Other Demand (af) Hot Tub Evap	0.000	(9)	80 2.113	
(3)	Sq. Ft. of Lawn Irrigated Lawn Application Rate (af/ac)	2.000 2.641	(10)	80 0.000	
(4)	Acres of Crop Irrigated Crop Application Rate (af/ac)	0.00 0.000	(9-10)	6100	

\*(12), (13) Total Includes 5% Transit Loss  
10% from Green Mtn.

**TABLE 1  
EVAPORATION CALCULATION - EXAMPLE <6,500 FEET HOT TUB**

Month	SEO Monthly Distribution	(1) Gross Lake Evaporation		(2) Average Precipitation		(3) Effective Precipitation		(4) Net Evaporation		(5) Total Evaporation (acre-feet)
		(feet)	(inches)	(feet)	(inches)	(feet)	(inches)	(feet)	(inches)	
January	3.0%	0.11	1.35	0.07	0.84	0.00	0.00	0.11	1.35	0.000
February	3.5%	0.13	1.58	0.07	0.79	0.00	0.00	0.13	1.58	0.000
March	5.5%	0.21	2.48	0.05	0.58	0.00	0.00	0.21	2.48	0.000
April	9.0%	0.34	4.05	0.11	1.35	0.00	0.00	0.34	4.05	0.000
May	12.0%	0.45	5.40	0.09	1.02	0.00	0.00	0.45	5.40	0.001
June	14.5%	0.54	6.53	0.14	1.73	0.00	0.00	0.54	6.53	0.001
July	15.0%	0.56	6.75	0.10	1.14	0.00	0.00	0.56	6.75	0.001
August	13.5%	0.51	6.08	0.17	1.99	0.00	0.00	0.51	6.08	0.001
September	10.0%	0.38	4.50	0.16	1.96	0.00	0.00	0.38	4.50	0.001
October	7.0%	0.26	3.15	0.13	1.57	0.00	0.00	0.26	3.15	0.000
November	4.0%	0.15	1.80	0.07	0.80	0.00	0.00	0.15	1.80	0.000
December	3.0%	0.11	1.35	0.11	1.32	0.00	0.00	0.11	1.35	0.000
	<b>100.0%</b>	<b>3.75</b>	<b>45.00</b>	<b>1.26</b>	<b>15.09</b>	<b>0.00</b>	<b>0.00</b>	<b>3.75</b>	<b>45.00</b>	<b>0.006</b>

(1) = Monthly distribution of gross annual evaporation rate in accordance with SEO General Criteria.

(2) = Monthly precipitation from local weather station.

(3) = Equal to 0 per State Policy No. 2004-3.

(4) = Net Evaporation = Column (1) - Column (3)

(5) = Column (4) x Open Water Surface Area (tbd acres) x Column (4) in feet.

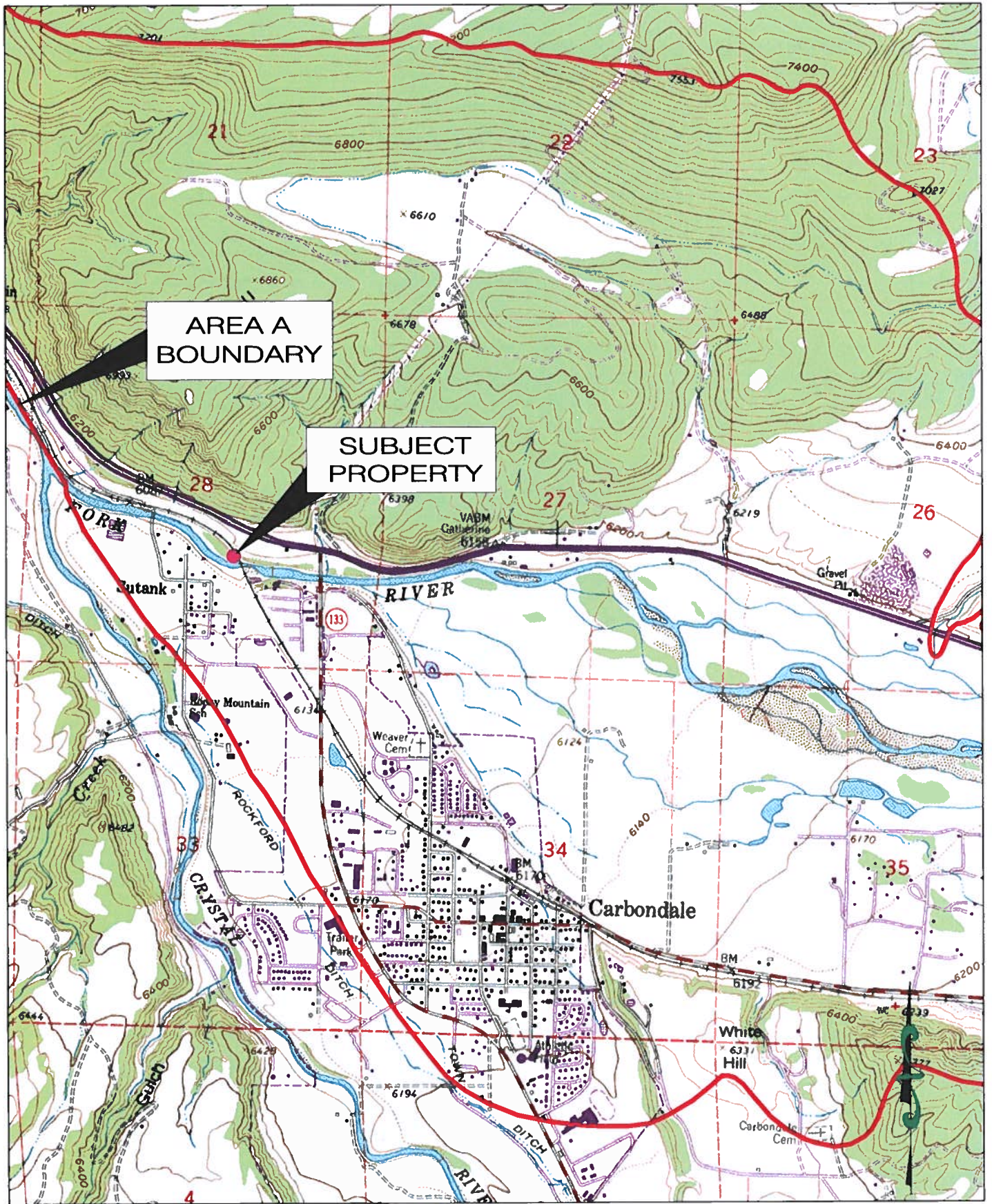

Figure 1: Stefan Dag

File: 033-72  
Date: 12/15/2017

Basalt Water Conservancy District



Scale: 1"=2,000'

**RESOURCE ENGINEERING, INC.**

809 Colorado Avenue  
Glenwood Springs, CO 81601  
(970) 945-6777 Voice 945-1137 Facsimile

**APPLICATION FOR WATER ALLOTMENT CONTRACT  
BASALT WATER CONSERVANCY DISTRICT**

**1. Applicant(s) Contact Information**

a. Name: STEFAN DAG

b. Mailing Address:

848 COUNTY RD. 106

CARBONDALE, CO 81623

c. Street Address:

d. Telephone Numbers: 970 963 8056 / 970-404-0559

e. Email Address: INFO@IGATES.US

f. If Applicant is represented by an Attorney, please provide the Attorney's contact information, including name, address, telephone, and email:

MM g. Emergency Local Contact Information, including name, address, telephone, and email:

EVA ALEXANDRA DAVIES - SPOUSE  
970-963-8056

h. Contact Information of property manager, caretaker, irrigator, system operator, or agent who should be provided a copy of this contract, including name, address, telephone, and email:

NA

**2. Type of land use (development) proposed for water allotment contract (i.e. single family home, subdivision, gravel pit, etc.):**

ADU 1280 Sq'

**3. Legal description and address of property on which District's water rights and/or contract water will be used (attach map and vesting deed with proof of ownership)\*:**

Basalt Water Conservancy District  
Water Allotment Application  
Page 2

4. Elevation of property: 6080<sup>1</sup> 6-7,000 ft., \_\_\_\_\_ 7-8,000 ft., \_\_\_\_\_ 8-9,000 ft.
5. Name and legal description of water supply diversion point(s):

MM Name of Diversion Drip Well 039575-F

Type of Diversion Well (e.g., a well spring, ditch, pipeline, etc.)

Legal Description: NW Quarter, SE Quarter, Section 28, Township 7  
N / S Range 88 E / W of the 6<sup>th</sup> Principal Meridian, at a location  
1700 feet from the S Section line and 2100 feet  
from the E Section line.

UTM Coordinates (NAD 83):

Northing: \_\_\_\_\_

Easting: \_\_\_\_\_

\_\_\_\_\_ Zone 12 / \_\_\_\_\_ Zone 13.

If diversion point is a well, please provide the Well Permit No. 39575-F

Is the well operational/active?  Yes, \_\_\_\_\_ No

Is there currently an operating well meter?  Yes, \_\_\_\_\_ No

Notice: A valid well permit with operating well meter will be required under the contract.

6. Legal Water Supply: (please check one)

MM  Applicant requests consideration by the District to be included in the District's Umbrella Plan for Augmentation decreed in Case No. 02CW77.\*

\*Note: Certain applicants may qualify to be included in the District's Umbrella Plan at the District's discretion. In order to be included in the District's Umbrella Plan, the Applicant's depletions must occur within the District's defined "Area A" and the Applicant must

WILL MAKE PAYMENTS

reimburse the District its pro rata share of the District's expenses in obtaining the Umbrella Plan decree. Costs of reimbursement are contingent upon location and intensity of the uses, and range from \$1,200 for contractees with less than 2 units (EQRs) in certain areas, to \$5,000 for more than 8 EQRs in Area A-3 (generally the Roaring Fork drainage above its confluence with the Fryingpan Rivers).

\_\_\_\_ Applicant will obtain its own plan for augmentation by applying to the Water Court, Water Division 5 within 2 years of this application. If Applicant has already applied for its own change/approval of plan for augmentation, the Water Court Case Number is: \_\_\_\_\_.

7. Proposed waste water treatment system: (please check)

- MM  Tap to central waste water treatment facility  
 Septic tank/leachfield system - DESIGNED BY GAMBA ARCHTS.  
 Evapotranspiration system  
 Other:

8. Proposed use of water (please check)

- Domestic/Municipal (single family home(s), duplex(s), condominium(s), mobile home(s), apartment). Please complete page four of this application.  
 Commercial (hotel, office, warehouse, restaurant, bar, retail). Please complete page five of this application.  
 Industrial (gravel pit, manufacturing). Please complete page six of this application.  
 Agricultural (crop irrigation, stock watering). Please complete page seven of this application.

Date on which the county or other applicable governmental entities approved the land use for which you seek legal water service: \_\_\_\_\_. (Note: Copy of the Resolution of other documentation evidencing such approval should be submitted with application.)

9. What other water rights are associated with or used on the property?

DOMESTIC IRRIGATION AS ALLOWED BY PERMIT AND CONTRACT 84

10. What other uses of water occur on the property?

JACOZZI

Please complete the section below if you selected domestic/municipal use on Page 3,  
No. 8

DOMESTIC/MUNICIPAL WATER USES

In-House

Single family residential home(s)	Number of Units: <u>ADU</u>
Duplex(s)	Number of Units: _____
Condominium(s)	Number of Units: _____
Apartment(s)	Number of Units/Rooms: _____
Mobile Home(s)	Number of Units: _____

Irrigation (lawns, parks, open space)

Total area to be irrigated 2000 Sq. Ft. or \_\_\_\_\_ Acres

Type of irrigation system (please check)

X Sprinkler

\_\_\_\_\_ Flood (irrigation ditch)

Domestic stock watering (cattle, horses)

Number of animals:

Period of use (months):

Other domestic/municipal uses not listed:

JACUZZI



Please complete this page if you selected commercial use on Page 3, No. 8

**COMMERCIAL WATER USES**

In-House

Hotel:

NA

Office(s), square footage: \_\_\_\_\_

Warehouse/distributor, square footage: \_\_\_\_\_

Retail, square footage: \_\_\_\_\_

Restaurant, number of seats: \_\_\_\_\_

Bar, number of seats: \_\_\_\_\_

Irrigation (lawns, parks, open space)

Total area to be irrigated \_\_\_\_\_ Sq. Ft. or \_\_\_\_\_ Acres

Type of irrigation system (please check)

\_\_\_\_\_ Sprinkler

\_\_\_\_\_ Flood (irrigation ditch)

Other Commercial Uses Not Listed:

Please complete this page if you selected industrial use on Page 3, No. 8

**INDUSTRIAL WATER USES**

Please describe your industrial development in some detail:

NA

Irrigation (lawns, parks, open space)

Total area to be irrigated \_\_\_\_\_ Sq. Ft. or \_\_\_\_\_ Acres

Type of irrigation system (please check)

\_\_\_\_\_ Sprinkler  
\_\_\_\_\_ Flood (irrigation ditch)

Please complete this page if you selected agricultural use on Page 3, No. 8.

**AGRICULTURAL WATER USE**

NA

**Irrigation**

Type of crop(s) (pasture, alfalfa, beans, etc.) and irrigation system:

Crop: _____	Acres: _____	Sprinkler: _____	Flood: _____
Crop: _____	Acres: _____	Sprinkler: _____	Flood: _____
Crop: _____	Acres: _____	Sprinkler: _____	Flood: _____
Crop: _____	Acres: _____	Sprinkler: _____	Flood: _____

**Stock Watering (cattle, horses)**

Number of animals:

Months of use:

**Other agricultural uses not listed:**

**VERIFICATION**

STATE OF Colorado )  
COUNTY OF Garfield ) ss.

I, STEFAN DAG (name of Applicant or Applicant's duly authorized representative), being first duly sworn, upon oath, depose and state as follows:

- 1) I am the Applicant or a duly authorized officer, manager, agent or attorney-in-fact for the Applicant for this Application for Water Allotment Contract;
- 2) I have read and know the contents of this Application;
- 3) The information contained herein is an accurate and complete description of the Applicant's intended use of the Basalt Water Conservancy District's water rights;
- 4) The Applicant acknowledges that the accuracy and truth of all statements in this Application are conditions of approval of this Application by the Basalt Water Conservancy District and of the Contract to be made pursuant to such approval; and
- 5) I acknowledge that this application shall be subject to the District's Water Allotment Contract as approved and issued by the District.

Date: 12/07/2017

By: 

Print Name: STEFAN DAG

Title: \_\_\_\_\_

Subscribed and sworn before me this 7 day of Dec, 2017  
by Stefan Dag

Witness my hand and seal.

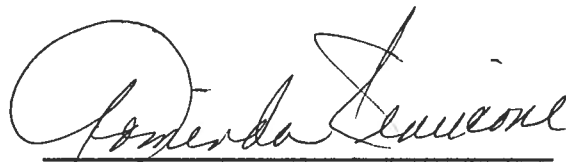

Notary Public

My commission expires:

